



# SHILOH CATTLE COMPANY

*Red & Black Angus*



## *Trendsetter Bull & Select Replacement Heifer Sale*

**Saturday March 22, 2025  
at the Ranch – Hand Hills Lake, Alberta**

**OFFERING: 35 PUREBRED RED ANGUS & BLACK ANGUS BULLS  
AND 50 RED & BLACK PUREBRED AND ANGUS/SIMMENTAL  
CROSSBRED REPLACEMENT HEIFERS**

# *Welcome to the 2025 Shiloh Cattle Company “Trendsetter” Bull & Replacement Heifer Sale.*

We would like to welcome you to our 11th annual Trendsetter Bull & Select Replacement Heifer Sale, here at the Ranch.

The conditions this past year have definitely improved from the past few years of drought, which we are incredibly grateful for, and as a result of the varying conditions of our climate, we feel that the resilience of our cattle herd is strongly reflected in the hardiness and quality of the bulls and heifers we have on offer this spring.

We pay a great deal of attention to what we feel are the important requirements in any progressive cattle herd. Qualities like foot and udder structure, positive maternal instincts, and calving ease, while still maintaining an impressive degree of performance. Our bull and heifer calves are expected to develop naturally along side their Dams. We do not creep feed.

We also find it incredibly important to listen and respond to our customers, and work with them to produce the best possible seed stock for their specific cattle operations. Please let us help you acquire the best bulls or replacement heifers for your breeding program.

Once weaned, all bull and heifer calves are fed a Hay/Green Feed/Pea Straw mix, as well as a 14% pellet ration based on 1% of their body weight, promoting a natural and healthy rate of development. We believe a balanced feed ration reflects in the longevity of our cattle.

Sale day is March 22nd, at the Ranch, 1/2 hour SW of Hanna, Alberta.

Directions to the Ranch can be found here in the catalog or by searching “Shiloh Cattle Company” on google earth.

All sale animals will be on display outside the Sale Barn on sale day, starting at 10:00 AM, but we welcome you to contact us anytime prior to sale day to come by and view the sale pens and cow herd. We would be honoured to show you around.

We will once again be hosting an Open House Tailgate Party on Sunday, March 16th, down by the sale pens one week prior to this year’s sale. Join us for a Bon Fire, Hotdogs and Refreshments and tour the sale pens in advance.

Sale time is at 12:30 PM, with a full Roast Beef Dinner between 11:00 AM - 12:30 PM.

Hospitality will be on offer before and after the sale. Please plan to stay for the social after the sale. We look forward to visiting with you all.

*Darcy & Blake*



# SHILOH CATTLE COMPANY

## Trendsetter Bull and Select Replacement Heifer Sale

Saturday, March 22, 2025 :: 12:30 PM

*If you are unable to attend this year's sale, all Phone or Sight Unseen Bids may be entrusted in complete confidence to any of the Sale Staff listed below.*

### Sale Staff



Auctioneer  
Danny Skeels ... 403-783-1217

### Consultants/Ring Men



Darryl Snider  
780-385-5561



Don Oberg  
780-678-6926

Sale Management  
Bohrson Marketing Services



### Sale Consultants



Joe Barnett  
403-465-2805



Aaron Birch  
403-485-5518



Grayden Kay  
780-872-1565



Alisha Minchau  
403-857-9563

Sale Clerk  
Roylene Bedson

Load Out Crew  
Billy Bedson  
Murray Morton

**Bulls will be available for viewing  
Sale Day at 10:00 AM.**

### Health

ALL BULLS HAVE BEEN VACCINATED - SEMEN TESTED AND VET CHECKED.  
SCROTAL MEASUREMENTS TO BE PROVIDED SALE DAY.

Shiloh Cattle Company retains the right to draw owners use semen on all bulls offered in the sale. This will be done before the sale, or at the new owners convenience and at our own cost.

### Delivery Options

If you choose to take your bulls home on sale day you will receive a \$100 DISCOUNT on your purchase "PER BULL".

Bulls will be delivered FREE OF CHARGE within 250 km. Delivery fees MAY APPLY for distances further than 250 km.

BULLS may be kept FREE OF CHARGE at Shiloh Cattle Company until May 1st/2024. A charge of \$3.00 per day will be charged after May 1st/2024 and animals must then be picked up by the purchaser at the ranch.

HEIFER PACKAGES are to be picked up sale day unless other arrangements are made. Please contact Darcy or Blake to discuss options.

ALL BULLS REMAINING AT THE RANCH MUST BE INSURED BY THE PURCHASER SALE DAY. For additional catalogs or more information please contact:

SHILOH CATTLE COMPANY  
PHONE: 403-665-2023  
CELL: 403-820-1830

### Insurance Available Sale Day

Canadian Farm Insurance Corporation  
Kolton Kasur ..... 780-387-8376

## SHILOH CATTLE COMPANY

Blake Morton ..... 403-820-4162  
Darcy Olesky ..... 403-820-1830  
Alisha Minchau..... 403-857-9563

**shilohcattle@netago.ca**  
**www.shilohcattle.com**

# SHILOH CATTLE COMPANY

**15%  
OF A LOT  
MEANS  
A LOT**

The Canadian Angus Foundation functions to preserve and expand the Angus breed for future generations through education, youth development, scientific and market research, and historical preservation and restoration. The Canadian Angus Foundation was incorporated in 1993 and is the charitable arm of the Canadian Angus Association. Donations are tax deductible.

*We are proud to support the*

## Canadian Angus Foundation Future 15 Program

With **YOUR** help we will continue to further our mission and the breed.

Since 2019 almost \$400,000 has been **INVESTED** in member education, awards, bursaries and youth scholarships.

\$295,000 invested in **ANGUS** research over the last six years leveraged an additional \$600,000 in grant funding.

\$75,000+ has been invested in history and archives, including the 2019 Canadian Angus history book.

*If you are interested in giving back or learning more about this initiative, please contact Belinda Wagner, Canadian Angus Foundation Executive Director at 306-537-1518 or email [bwagner@cdnangus.ca](mailto:bwagner@cdnangus.ca). You can also visit the Canadian Angus Foundation website at [www.cdnangus.ca/foundation](http://www.cdnangus.ca/foundation)*

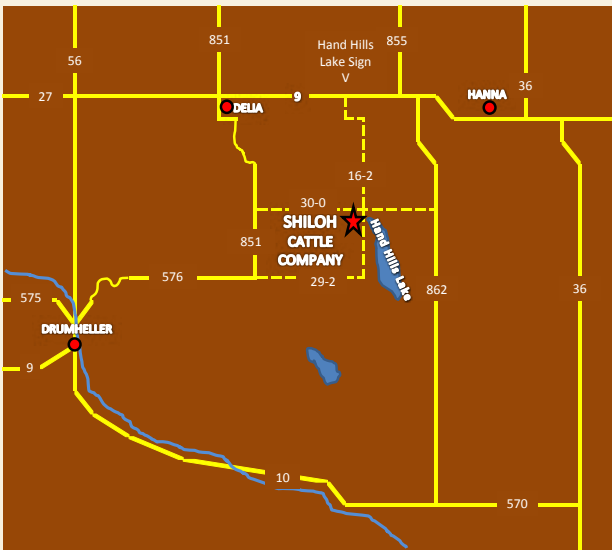

From Drumheller - Go east on Hwy # 576 for 29 km.

- Then turn north (Left) onto Hwy # 851 for 6.5 km.
- Then turn east (right) onto township Rd. 300 for 11.5 km. (At Shiloh Cattle Co. Sign)
- Then turn south (right) onto Range Rd. 162. (At Shiloh Cattle Co. Sign)
- First driveway on the right. (Overhead Ranch Gate)

From Hanna - Take Hwy 9 West for 8.5 km.

- Then turn south (left) onto Secondary Hwy # 862 for 13.7 km.
- Then turn west (right) onto township Rd. # 300 .
- Then turn south (left) onto Range Rd. # 162. (At Shiloh Cattle Co. Sign)
- First driveway on the right. (Overhead Ranch Gate)

From Delia - Take Hwy # 851 south.

- Then turn east (left) onto township Rd. 300 for 11.5 km. (At Shiloh Cattle Co. Sign)
- Then turn south (right) onto Range Rd. #162 (At Shiloh Cattle Co. Sign)
- First driveway on the right. (Overhead Ranch Gates)

You can find us on Google Maps. For directions to the ranch just search "Shiloh Cattle Company".

Internet Bidding Available

**D | L | M | S**  
*www.dlms.ca*

For more information call DLMS:  
Mark Shologan 780.699.5082 or  
DLMS Purebred Team 780.991.3025

### Calving Ease Scores

- ★★★★ Suitable for use on heifers - should produce minimal calving issues
- ★★★ Suitable for use on larger framed heifers
- ★★ Recommended for second calvers and cows
- ★ Recommended for mature cows

*Photographer: Jordie Buba*

We were not in the market for a new black herd sire when we purchased Refine, but the moment we saw him, we knew we had to have him in our breeding program. Refine is as deep ribbed, thick and stout made as they come, and stands on a perfect foot. His donor Dam made a strong impression on us and his Sire's reputation speaks for itself with overly impressive EPDs and Pedigree.



*Sire* **Allison Refine 78K**  
 ARA 78K      2277474      January 25 2022

**Sire:** BLACK WHEEL DRACARYS 178E  
 BLACK WHEEL DRACARYS 86G  
 RED WHEEL ANNE 93B

**Dam:** RED U-2 JUSTIFIED 235Z  
 RED BAR-E-L AB BRAND 25B  
 RED BAR-E-L MEG 64Y

BROOKING BANK NOTE 4040  
 BLACK WHEEL JESTRESS 1Y  
 RED BAR-E-L AB MAGIC MIKE 189Z  
 RED WHEEL ANN 69Y

RED U-2 MAMA'S BOY 167X  
 RED U-2 DUCHESS 386X  
 RED ANCHOR 1 DUKE 177U  
 RED BBK MEG 857T

Act. BW	Adj. WW	BW	Canadian Angus Association		EPDs		MCE
			WW	YW	Milk	CE	
73	716	-2.2	46	87	26	12	11

Here's a real solid Refine son with some calving ease built in. An attractive, thick made, strong boned bull with a real solid foot like his sire. His Grand Dam has provided us with many standout offspring including a Herd Sire. Take a real good look at this potential Herd Sire.



*Lot 1* **Red Shiloh Mr. Refine 5M**  
 SCCA 5M      2359229      January 07 2024

**Sire:** BLACK WHEEL DRACARYS 86G  
 ALLISON REFINE 78K  
 RED BAR-E-L AB BRAND 25B

**Dam:** RED SHILOH HOLLYWOOD 129H  
 RED SHILOH COLOSOLITE 36K  
 RED SHILOH CAN'T TOUCH THIS 3C

BLACK WHEEL DRACARYS 178E  
 RED WHEEL ANNE 93B  
 RED U-2 JUSTIFIED 235Z  
 RED BAR-E-L MEG 64Y

RED DKF RACER 8E  
 RED LAURON MOROJITTI 127A  
 RED VIKSE FULLY LOADED 29Y  
 RED TOMAHAWK COLOSOLITE 69S

Act. BW	Adj. WW	BW	Canadian Angus Association		EPDs		MCE	CE Score
			WW	YW	Milk	CE		
78	664	0	36	70	24	7	9	★★★

# SHILOH CATTLE COMPANY



Here's an extremely attractive and masculine Allison Refine 78K son. He is big middled and muscled. From a birth weight of 69lbs to a weaning weight of 721lbs this bull is sure to put the pounds on your calves. Keeping in mind he is also out of a first calve heifer, he is sure to impress. Shiloh Refine Son 56M will work well on larger framed heifers and cows.

## Lot 2 Shiloh Refine Son 56M

AMCC 56M 2350252 January 20 2024

Act. BW	Adj. WW	BW	Canadian Angus Association EPDs				MCE	CE Score
			WW	YW	Milk	CE		
69	721	-1.1	50	85	24	8	9	★★★

BLACK WHEEL DRACARYS 86G  
Sire: **ALLISON REFINE 78K**  
RED BAR-E-L AB BRAND 25B

BLACK WHEEL DRACARYS 178E  
RED WHEEL ANNE 93B  
RED U-2 JUSTIFIED 235Z  
RED BAR-E-L MEG 64Y

RED SHILOH GUNNER 23G  
Dam: **RED SHILOH ROSETTE 80K**  
RED SHILOH GREAT WINE 68G

RED COCKBURN ASSASSIN 624D  
RED LAURON ARDATH 185A  
RED CIRCLE G CARGO 8C  
RED SHILOH CHARDONNAY 24C



Here's an eye catching heifer bull who gets better by the day! Red Shiloh More Refined 88M is much like his sire, he is wide topped, smooth shouldered and sure footed. He is sure to provide you with excellent females in your replacement pen. On his dams side the Red Six Mile Mr Wick 169H has done a fantastic job of producing well balanced and uddered females here at Shiloh Cattle Company.

## Lot 3 Red Shiloh More Refined 88M

AMCC 88M 2358683 January 31 2024

Act. BW	Adj. WW	BW	Canadian Angus Association EPDs				MCE	CE Score
			WW	YW	Milk	CE		
79	723	-0.5	42	79	25	8	8	★★★★

BLACK WHEEL DRACARYS 86G  
Sire: **ALLISON REFINE 78K**  
RED BAR-E-L AB BRAND 25B

BLACK WHEEL DRACARYS 178E  
RED WHEEL ANNE 93B  
RED U-2 JUSTIFIED 235Z  
RED BAR-E-L MEG 64Y

RED SIX MILE MR WICK 169H  
Dam: **RED SHILOH ROSETTE 72K**  
RED SHILOH HOLLY 49H

RED SIX MILE JOHN WICK 882E  
RED SIX MILE RUBY 233E  
RED SHILOH ENTERPRISE 78E  
RED SHILOH DELIGHTFUL 34D

# SHILOH CATTLE COMPANY

Lots of natural muscle and hip shape in this guy. A calving ease option with an impressive degree of performance as well. Lot 4 comes from a strong maternal line of females. We strongly considered keeping this guy in our herd. He will make an excellent addition to any breeding program and we look forward to seeing him make a positive impact at his new home.



*Lot*  
**4**     *Red Shiloh Mr. Refine 103M*  
 SCCA 103M     2359826     February 07 2024

Act. BW	Adj. WW	BW	Canadian Angus Association EPDs	CE Score
WW	YW	Milk	CE	MCE
67	688	0.8	46   85   25   5   8	★★★★

BLACK WHEEL DRACARYS 86G  
*Sire: ALLISON REFINE 78K*  
 RED BAR-E-L AB BRAND 25B

BLACK WHEEL DRACARYS 178E  
 RED WHEEL ANNE 93B  
 RED U-2 JUSTIFIED 235Z  
 RED BAR-E-L MEG 64Y

RED ALLISON RED BONE 69E  
*Dam: RED SHILOH ROSETTE 50K*  
 RED SHILOH BANDITA 38B

RED WPRA RIGHT TURN C521  
 RED BAR-E-L BESS 214C  
 RED SCCA U.N. MAJOR 35U  
 RED SHILOH TOPAZ 15T



# SHILOH CATTLE COMPANY



Colossal continues to impress us with his offspring. His calves are strong boned and thick made with outstanding weaning weight and yearling weight ratios. The females we have retained in our herd are developing beyond our expectations and we are more than excited to watch them mature, as they are sure to become cornerstone females in our program. Colossal produced our Grand Champion pen of purebred heifers at the Medicine Hat Pen Show in December.

*Sire* **Roy Mac Colossal 57J**  
KSM 57J      2227374      January 25, 2021

Act. BW	Adj. WW	Adj. YW	Canadian Angus Association EPDs					
BW	WW	YW	BW	WW	YW	Milk	CE	MCE
95	n/a	n/a	4.1	55	94	18	-2.0	5.0

EF COLOSSAL 520  
*Sire:* **BAR-E-L ICEBERG QUEST 75G 108501**  
BAR-E-L BRIDE 159D

EXAR CLASSEN 1422B  
EXAR BLACKBIRD 5877  
MUSGRAVE BIG SKY  
DBRL 94T BRIDE 4W

RING CREEK EL TIGRE 9X  
*Dam:* **BELVIN LADY BLOSSOM 58'13**  
BELVIN LADY BLOSSOM 84'10

HF EL TIGRE 28U  
RING CREEK AMBUSH LADY 10S  
BELVIN REBEL 33'05  
BELVIN LADY BLOSSOM 79'05



A Colossal son with a little more height to get those larger framed heifers and second calvers bred with ease. All 3 of his young Dam's offspring have made our sale or have been retained in our herd. The Essence cow family is known for it's impressive, productive females.

*Lot* **Shiloh Mr. Colossal 53M**  
**5**      SCCA 53M      2359614      January 20 2024

Act. BW	Adj. WW	BW	Canadian Angus Association EPDs						CE Score
BW	WW	BW	WW	YW	Milk	CE	MCE	★★	
83	683	3.9	55	92	19	0	6		

BAR-E-L ICEBERG QUEST 75G  
*Sire:* **ROY MAC COLOSSAL 57J**  
BELVIN LADY BLOSSOM 58'13

EF COLOSSAL 520  
BAR-E-L BRIDE 159D  
RING CREEK EL TIGRE 9X  
BELVIN LADY BLOSSOM 84'10

FIRST IMPRESSION 4420  
*Dam:* **SHILOH ESSENCE 1H**  
DMM ESSENCE 77F

DAMERON FIRST IMPRESSION  
M A F MISS JETSTREAM 2928  
DMM STACK 8D  
DMM ESSENCE 51D



A stylish bull with a smooth front third. These Colossal sons always impress us. This guy is sure to make outstanding replacement heifers.



*Lot*  
**6** *Shiloh Mr. Colossal 62M*  
SCCA 62M      2359622      January 22 2024

Act. BW	Adj. WW	BW	Canadian Angus Association EPDs				MCE	CE Score
			WW	YW	Milk	CE		
80	601	2.6	46	78	16	3	7	★★★

BAR-E-L ICEBERG QUEST 75G  
**Sire: ROY MAC COLOSSAL 57J**  
BELVIN LADY BLOSSOM 58'13

EF COLOSSAL 520  
BAR-E-L BRIDE 159D  
RING CREEK EL TIGRE 9X  
BELVIN LADY BLOSSOM 84'10

DMM STACK 8D  
**Dam: DMM MISS ESSENCE 4H**  
DMM MISS ESSENCE 90F

74-51 SUDDEN LOOK 1023  
DMM MISS ESSENCE 14Y  
S A V SENSATION 5615  
DMM MISS ESSENCE 5C

An eye catching, calving ease bull with a smooth shoulder. Lot 7's Dam is a solid female with a beautiful udder. This guy has been a pen favourite from the moment he hit the ground.



SCCA 92H - Maternal Sib



*Lot*  
**7** *Shiloh Mr. Colossal 71M*  
SCCA 71M      2359632      January 24 2024

Act. BW	Adj. WW	BW	Canadian Angus Association EPDs				MCE	CE Score
			WW	YW	Milk	CE		
75	738	0.3	48	73	20	6	9	★★★★

BAR-E-L ICEBERG QUEST 75G  
**Sire: ROY MAC COLOSSAL 57J**  
BELVIN LADY BLOSSOM 58'13

EF COLOSSAL 520  
BAR-E-L BRIDE 159D  
RING CREEK EL TIGRE 9X  
BELVIN LADY BLOSSOM 84'10

LAURON BREAKIN BAD 93B  
**Dam: SHILOH ECLIPSE 130E**  
RED LAURON JILL 56B

S A V BRILLIANCE 8077  
RED LAURON JILL 48U  
RED LAURON WRANGLER JO 45W  
RED LAURON JILL 107Y

# SHILOH CATTLE COMPANY



Here's a solid Colossal son out of one of our donor females. A bull with a notably impressive phenotype, he is as long sided and sure footed as his sire, with the performance of his Dam. We believe this guy will make stunning females and outstanding bull calves. 3 of his Paternal sisters made up our Grand Champion pen of purebred heifers at the Medicine Hat Pen Show this past fall.



*DMM Miss Essence 1G - Dam*

Lot <b>8</b>	<b>Shiloh Mr. Colossal 120M</b>							CE Score <b>★★★</b>
SCCA 120M	2359848	February 23 2024						
Act. BW	Adj. WW	BW	Canadian Angus Association EPDs		Milk	CE	MCE	
89	776	4.2	66	110	20	0	5	

BAR-E-L ICEBERG QUEST 75G  
**Sire: ROY MAC COLOSSAL 57J**  
 BELVIN LADY BLOSSOM 58'13

DMM STACK 8D  
**Dam: DMM MISS ESSENCE 1G**  
 DMM MISS ESSENCE 39E

EF COLOSSAL 520  
 BAR-E-L BRIDE 159D  
 RING CREEK EL TIGRE 9X  
 BELVIN LADY BLOSSOM 84'10

74-51 SUDDEN LOOK 1023  
 DMM MISS ESSENCE 14Y  
 NORTHERN VIEW SMW GUSTOV 3Z  
 DMM MISS ESSENCE 7A

*The story behind our cover photo.*



*The Red Angus bull on the cover of this year's catalog was painted by Angela Davidson, a well known artist from England. Angela is world renowned for her fine paintings of all types of animals and livestock, including several other breeds of cattle. We purchased this limited print at the Canadian Angus fundraiser auction a few years ago. It was commissioned for the Canadian Angus Association and the CAA has the exclusive rights to this impressive piece of artwork. We would like to thank the artist and the CAA for granting us permission to use it in our 2025 sale catalog.*

Our largest Sire Group this year comes out of our Six Mile John Wick son. Mr. Wick is extremely long sided, deep ribbed and clean fronted, offering calving ease and performance. His calves come easy and are as attractive, dark coated and sure footed as their sire.



*Sire* **Red Six Mile Mr Wick 169H**  
 SIXM 169H      2164365      February 21, 2020

RED U-2 RECKONING 149A  
**Sire: RED SIX MILE JOHN WICK 882E**  
 RED SIX MILE & CO GLORIA 29A

RED U-2 RECON 192Y  
 RED U-2 ANEXA 271Y  
 RED 6 MILE FULL THROTTLE 171T  
 RED SIX MILE GLORIA 746W

RED HALL'S BARRY 040C  
**Dam: RED SIX MILE RUBY 233E**  
 RED SVR RUBY 16P

RED NORTHLINE ROB ROY 122K MAF  
 RED BLAIRS ELORA 40X  
 RED YY RED KNIGHT 640F  
 RED LAMBS RUBY

Canadian Angus Association EPDs									
Act.	Adj.	Adj.							
BW	WW	YW	BW	WW	YW	Milk	CE	MCE	
74	768	1376	1.4	48	81	28	4	8	

14M hits the mark on several levels. A solid made bull with above average calving ease and performance, as well as an impressive milk EPD of +27. Put him to work in your cow herd.



*Lot* **Red Shiloh Mr. Wick 14M**  
**9**      SCCA 14M      2359247      January 09 2024

RED SIX MILE JOHN WICK 882E  
**Sire: RED SIX MILE MR WICK 169H**  
 RED SIX MILE RUBY 233E

RED U-2 RECKONING 149A  
 RED SIX MILE & CO GLORIA 29A  
 RED HALL'S BARRY 040C  
 RED SVR RUBY 16P

RED LAURON WRANGLER JO 45W  
**Dam: RED LAURON JILL 56B**  
 RED LAURON JILL 107Y

RED SIX MILE SAKIC 832S  
 RED LAURON KORUBA 17P  
 RED BAR-E-L RENEGADE 202R  
 RED LAURON JILL 48U

Canadian Angus Association EPDs									CE Score
Act.	Adj.	BW	WW	YW	Milk	CE	MCE		★ ★ ★
80	680	1.1	44	69	27	4	9		

# SHILOH CATTLE COMPANY



This guy's got it all. Calving ease, performance and milk EPDs all above breed average. These Mr. Wick sons stand on a solid foot structure, just like their sire.

**Lot 10** *Red Shiloh Mr. Wick 36M*  
 SCCA 36M 2359285 January 15 2024

Act. BW	Adj. WW	BW	Canadian WW	Angus YW	Association Milk	EPDs CE	MCE	CE Score
85	698	0.6	44	77	26	5	6	★★★★

Sire: RED SIX MILE JOHN WICK 882E  
 RED SIX MILE MR WICK 169H  
 RED SIX MILE RUBY 233E

RED U-2 RECKONING 149A  
 RED SIX MILE & CO GLORIA 29A  
 RED HALL'S BARRY 040C  
 RED SVR RUBY 16P

Dam: RED TOP GRADE EYE CANDY 45A  
 RED LAURON JILL 108C  
 RED LAURON JILL 3X

TER-RON PARK PLACE 18Y  
 RED TG LETTE 68R  
 RED LAURON UNEQUAL 31U  
 RED LAURON JILL 16U



Another calving ease option from this sire group. Lot 11's maternal Grand Sire provided us with 3 CAA Champions. Maternal brother sold to Kingsview Farm, Lindsay, Ontario.

**Lot 11** *Red Shiloh Mr. Wick 61M*  
 SCCA 61M 2359621 January 22 2024

Act. BW	Adj. WW	BW	Canadian WW	Angus YW	Association Milk	EPDs CE	MCE	CE Score
75	648	0.7	39	63	26	6	9	★★★★

Sire: RED SIX MILE JOHN WICK 882E  
 RED SIX MILE MR WICK 169H  
 RED SIX MILE RUBY 233E

RED U-2 RECKONING 149A  
 RED SIX MILE & CO GLORIA 29A  
 RED HALL'S BARRY 040C  
 RED SVR RUBY 16P

Dam: RED ML HUSTLER 272Z  
 RED SHILOH FANTASIA 31F  
 RED SHILOH A LOADED LADY 14A

RED BECKTON HUSTLER T615 C2  
 RED ML KARUBA 814U  
 RED VIKSE FULLY LOADED 29Y  
 RED TOMAHAWK ROSETTE 17S



SCCA 31F - Dam

An long sided, strong topped, attractively made Mr. Wick son. This smooth shouldered bull excels in calving ease and weaning weight. A great addition to any breeding program .



*Lot*  
**12** *Red Shiloh Mr. Wick 63M*  
SCCA 63M 2359623 January 22 2024

RED SIX MILE JOHN WICK 882E  
**Sire: RED SIX MILE MR WICK 169H**  
RED SIX MILE RUBY 233E

RED U-2 RECKONING 149A  
RED SIX MILE & CO GLORIA 29A  
RED HALL'S BARRY 040C  
RED SVR RUBY 16P

RED SCCA XCITEABULL SAKIC 5X  
**Dam: RED SHILOH CHARRO 65C**  
RED SHILOH ZIPPY PURSUIT 1Z

RED SIX MILE SAKIC 832S  
RED TOMAHAWK ROSETTE 36S  
RED LONE STONE PURSUIT 81W  
RED TOMAHAWK DUCHESS 43S

Act. BW	Adj. WW	BW	Canadian WW	Angus YW	Association Milk	EPDs CE	MCE	CE Score
80	751	-0.3	47	71	24	8	11	★★★★

Another well put together bull in this sire group. This guys Dam is a dark red female with a real solid udder. His maternal Grand Dam achieved Elite/Premier Dam status in 2020.



*Lot*  
**13** *Red Shiloh Mr. Wick 68M*  
SCCA 68M 2359628 January 24 2024

RED SIX MILE JOHN WICK 882E  
**Sire: RED SIX MILE MR WICK 169H**  
RED SIX MILE RUBY 233E

RED U-2 RECKONING 149A  
RED SIX MILE & CO GLORIA 29A  
RED HALL'S BARRY 040C  
RED SVR RUBY 16P

RED SHILOH ACTIVELY LOADED 81A  
**Dam: RED SHILOH CHARTREUSE 85C**  
RED SHILOH AN AFFAIR 84A

RED VIKSE FULLY LOADED 29Y  
RED SHILOH UNA 4U  
RED ANCR 16U STATED 47X  
RED SHILOH UPPER CLASS 16U

Act. BW	Adj. WW	BW	Canadian WW	Angus YW	Association Milk	EPDs CE	MCE	CE Score
98	697	3.1	41	71	25	-2	6	★★

# SHILOH CATTLE COMPANY



A performance driven bull that is sure to catch your attention. Deep sided with an attractive presence.

Lot **14** *Red Shiloh Mr. Wick 73M*  
 SCCA 73M 2359634 January 25 2024

Act. BW	Adj. WW	BW	Canadian WW	Angus YW	Association Milk	EPDs CE	MCE	CE Score
88	747	1.8	53	88	24	0	5	★★

Sire: RED SIX MILE JOHN WICK 882E  
 RED SIX MILE MR WICK 169H  
 RED SIX MILE RUBY 233E

RED U-2 RECKONING 149A  
 RED SIX MILE & CO GLORIA 29A  
 RED HALL'S BARRY 040C  
 RED SVR RUBY 16P

Dam: RED MAR MAC DEBUT 70D  
 RED SHILOH GUIDANCE 99G  
 RED LAURON ARDATH 103B

RED WINDY HILL ZEPPELIN 1240Z  
 RED MCRAE'S RUBY 10T  
 RED GLACIER LOGAN  
 RED LAURON ARDATH 1P



A solid made Mr. Wick son with a strong BW and WW ratio. Maternal brothers are working at Cottonwood Livestock and Kokay Farms.

Lot **15** *Red Shiloh Mr. Wick 80M*  
 SCCA 80M 2359640 January 28 2024

Act. BW	Adj. WW	BW	Canadian WW	Angus YW	Association Milk	EPDs CE	MCE	CE Score
86	656	1.5	42	69	22	4	7	★★★

Sire: RED SIX MILE JOHN WICK 882E  
 RED SIX MILE MR WICK 169H  
 RED SIX MILE RUBY 233E

RED U-2 RECKONING 149A  
 RED SIX MILE & CO GLORIA 29A  
 RED HALL'S BARRY 040C  
 RED SVR RUBY 16P

Dam: RED GJP THOR 255A  
 RED SHILOH DESEREE 16D  
 RED SHILOH ZEPHYR 29Z

RED MAJESTIC LIGHTNING 717SGMR  
 RED SIX MILE MS PATHY 255T  
 RED SCCA U.N. MAJOR 35U  
 RED TOMAHAWK ROSETTE 20N

93M's Dam is a solid milking, deep sided cow with a strong foot. Repeat customer, Rod Nelson has purchased 2 of his maternal siblings in recent sales. A good option for your larger framed heifers or cows.



*Lot*  
**16** *Red Shiloh Mr. Wick 93M*  
SCCA 93M 2359650 February 02 2024

Act. BW	Adj. WW	BW	Canadian WW	Angus YW	Association Milk	EPDs CE	MCE	CE Score
78	687	1.2	36	60	28	4	6	★★★

Sire: RED SIX MILE JOHN WICK 882E  
**RED SIX MILE MR WICK 169H**  
RED SIX MILE RUBY 233E

RED U-2 RECKONING 149A  
RED SIX MILE & CO GLORIA 29A  
RED HALL'S BARRY 040C  
RED SVR RUBY 16P

RED WILDMAN CHUCK NORRIS 012X  
**Dam: RED SHILOH CANADIAN GAL 32C**  
RED SHILOH YOU MISS MOOSE 93Y

RED WILDMAN RIO GRANDE 520R  
RED DWAJO PRALEE 78M  
RED SCCA UNSUNG MARIAS 86U  
RED SHILOH WHO'S WHO 23W

A calving ease option with a strong milk EPD of +26. Put him to work in your replacement heifer pen this spring.



*Lot*  
**17** *Red Shiloh Mr. Wick 95M*  
SCCA 95M 2359652 February 04 2024

Act. BW	Adj. WW	BW	Canadian WW	Angus YW	Association Milk	EPDs CE	MCE	CE Score
78	676	0.1	43	71	25	5	7	★★★★

Sire: RED SIX MILE JOHN WICK 882E  
**RED SIX MILE MR WICK 169H**  
RED SIX MILE RUBY 233E

RED U-2 RECKONING 149A  
RED SIX MILE & CO GLORIA 29A  
RED HALL'S BARRY 040C  
RED SVR RUBY 16P

RED CIRCLE G CARGO 8C  
**Dam: RED SHILOH GENEROSITY 41G**  
RED LAURON ANGIE 107B

RED XO CROWFOOT REBEL 2422Z  
RED CG THELMA 119Y  
RED MAC PACKER 136Z  
RED ALALTA ACRES ANGIE 7U

# SHILOH CATTLE COMPANY



A well put together bull to consider for your cow pen that excels in milk and above average WW EPDs.

Lot **18** *Red Shiloh Mr. Wick 108M*  
 SCCA 108M 2359830 February 11 2024

Sire: RED SIX MILE JOHN WICK 882E  
 RED SIX MILE MR WICK 169H  
 RED SIX MILE RUBY 233E

RED U-2 RECKONING 149A  
 RED SIX MILE & CO GLORIA 29A  
 RED HALL'S BARRY 040C  
 RED SVR RUBY 16P

Dam: RED GLACIER LOGAN  
 RED LAURON LASS 77B  
 RED LAURON LASS 117U

RED BUFFALO CREEK VC CHIEF 105  
 RED GLACIER REBALAS  
 RED LAZY R C MONTE CARLO 375N  
 RED LAURON LASS 55L

Act. BW	Adj. WW	BW	Canadian Angus Association EPDs				MCE	CE Score
			WW	YW	Milk	CE		
83	693	1.6	43	71	29	-1	5	

CE Score  
★★



Here's a Mr. Wick son to take a good look at, with above board calving ease, performance and milk. We really like this guys Dam. She is a solid structured female with a well balanced udder.

Lot **19** *Red Shiloh Mr. Wick 109M*  
 SCCA 109M 2359831 February 11 2024

Sire: RED SIX MILE JOHN WICK 882E  
 RED SIX MILE MR WICK 169H  
 RED SIX MILE RUBY 233E

RED U-2 RECKONING 149A  
 RED SIX MILE & CO GLORIA 29A  
 RED HALL'S BARRY 040C  
 RED SVR RUBY 16P

Dam: RED LAURON DEMOLITION 28D  
 RED SHILOH HOTTIE 126H  
 RED SHILOH DAISY DUKE 74D

RED LAURON BLOCK BUSTER 78B  
 RED LAURON JILL 107Y  
 RED GJP THOR 255A  
 RED SHILOH ALLELUIA 77A

Act. BW	Adj. WW	BW	Canadian Angus Association EPDs				MCE	CE Score
			WW	YW	Milk	CE		
80	693	0.8	44	75	25	5	8	

CE Score  
★★★★



Rumble is notably one of the thickest, long sided and sound footed Red bulls around. He has an astounding presence that is reflected in the attractiveness of his heifer calves, as well as his bull calves. As his popularity increases, we are looking forward to seeing more of his offspring this spring across North America, as well as in Australia.



*Sire* **Red DMM Rumble 74J**  
DMM 74J      2227974      February 17, 2021

Act.	Adj.	Adj.	Canadian Angus Association				EPDs	
BW	WW	YW	BW	WW	YW	Milk	CE	MCE
80	798	n/a	0.8	41	71	31	7	7

RED LWNBRG HARVESTOR 103C  
**Sire: RED GOAD MESSIN' AROUND 144'18**  
RED GOAD REBA 122'11  
RED GOAD BARNBURNER 132'12  
**Dam: GOAD PRIDE 153'14**  
AVELYN PRIDE 707'12  
AVELYN PRIDE 707'09

TED HARVESTOR 154A  
RED LWNBRG CADENCE 141Y  
RED TER-RON WALKABOUT 161W  
RED BAR-X MISS SODAK 137L  
RED DMM GLESBAR BARNANCE 35X  
RED VIKSE STARS QUEEN 73W  
SCC POWER ONE 50W

The front pasture appeal of this Rumble son is sure to catch your eye the moment you see him. Six of his Dam's offspring have sold in previous sales, as have many of his highly decorated sire's offspring. This is a calving ease bull worth a hard look when touring this year's sale pen.



*Lot* **Red Shiloh Mr. Rumble 6M**  
**20a**      SCCA 6M      2359231      January 07 2024

Act.	Adj.		Canadian Angus Association				EPDs		CE Score
BW	WW	BW	WW	YW	Milk	CE	MCE	★★★★★	
81	725	0.7	42	71	27	6.0	8.0		

RED GOAD MESSIN' AROUND 144'18  
**Sire: RED DMM RUMBLE 74J**  
GOAD PRIDE 153'14  
RED SHILOH ACTIVELY LOADED 81A  
**Dam: RED SHILOH CARMA 64C**  
RED SHILOH AUGUSTA 50A

RED LWNBRG HARVESTOR 103C  
RED GOAD REBA 122'11  
RED GOAD BARNBURNER 132'12  
AVELYN PRIDE 707'12  
RED VIKSE FULLY LOADED 29Y  
RED SHILOH UNA 4U  
RED SCCA UNSUNG MARIAS 86U  
RED SHILOH TACITA 12T

# SHILOH CATTLE COMPANY



Just like his brother, Lot 20A, there's more outstanding calving ease built into this guy. These Rumble sons are solid built .

Lot **20b** *Red Shiloh Mr. Rumble 105M*  
 SCCA 105M      2359828      February 08 2024

Sire: RED GOAD MESSIN' AROUND 144'18  
 RED DMM RUMBLE 74J  
 GOAD PRIDE 153'14

Dam: RED TER-RON HURRICANE 88Z  
 RED SHILOH BEWITCHED 55B  
 RED SHILOH ZARLA 20Z

RED LWNBRG HARVESTOR 103C  
 RED GOAD REBA 122'11  
 RED GOAD BARNBURNER 132'12  
 AVELYN PRIDE 707'12

RED THAT'LL DO UNBELIEVABLE 6U  
 RED TER-RON DIAMOND MIST 152W  
 RED ANCR 16U STATED 47X  
 RED SHILOH WALK ABOUT 34W

Act. BW	Adj. WW	BW	Canadian Angus Association EPDs				MCE	CE Score
			WW	YW	Milk	CE		
72	650	0.7	35	60	23	7	9	★★★★



123M is a strong combination of Red ML Hustler 272Z genetics and Red DMM Rumble 74J. Much like his sire he is as long and deep bodied as they come. Red Shiloh Lets Rumble 123M is out of the dam that raised the 2021 Trendsetter Bull sale high seller going to Yarrow Creek Ranch. Red Shiloh Lets Rumble is ready to o to work on your cow herd this spring.

Lot **21** *Red Shiloh Lets Rumble 123M*  
 AMCC 123M      2358682      February 24 2024

Sire: RED GOAD MESSIN' AROUND 144'18  
 RED DMM RUMBLE 74J  
 GOAD PRIDE 153'14

Dam: RED ML HUSTLER 272Z  
 RED SHILOH FAVORITE GAL 19F  
 RED SHILOH ALBERTA GAL 85A

RED LWNBRG HARVESTOR 103C  
 RED GOAD REBA 122'11  
 RED GOAD BARNBURNER 132'12  
 AVELYN PRIDE 707'12

RED BECKTON HUSTLER T615 C2  
 RED ML KARUBA 814U  
 RED SCCA XCITEABULL SAKIC 5X  
 RED SHILOH YOU R WOMAN 22Y

Act. BW	Adj. WW	BW	Canadian Angus Association EPDs				MCE	CE Score
			WW	YW	Milk	CE		
94	730	2.3	47	82	31	1	4	★

Hustler is a performance driven sire that maintains a comfortable degree of calving ease. We purchased and walked him here at the ranch for 5 years on both replacement heifers as well as mature cows. We continue to use him in our AI program due to his popularity with our buyers.



*Sire* **Red ML Hustler 272Z**  
**VENO 272Z**      1709866      April 9, 2012

RED BECKTON HUSTLER C2 L079  
**Sire: RED BECKTON HUSTLER T615 C2**  
 RED BECKTON ROSE H074 EP

RED BECKTON HUSTLER CN J102  
 RED BECKTON BARMAID J012 CO  
 RED BECKTON EPIC K F075  
 RED BECKTON ROSE F791 EM R

RED CROWFOOT 6253S  
**Dam: RED ML KARUBA 814U**  
 RED BAR-X KARUBA 101J

CROWFOOT MAX 1743L  
 CROWFOOT PIED PIPER 3859N  
 RED BECKTON CLIPPER D225 JM  
 RED CROWFOOT KARUBA 60B

Canadian Angus Association EPDs									
Act. BW	Adj. WW	Adj. YW	BW	WW	YW	Milk	CE	MCE	
78	659	n/a	2.7	62	104	27	3	5	

A ML Hustler son stands on a very strong foot. He is deep sided and strong topped with impressive hip and rib shape. These Hustler bulls have been a big hit with many of our repeat customers. A performance driven, calving ease option.



*Maternal Sister - SCCA 47L*  
 2024 high selling Red Angus Heifer.

*Lot* **Red Shiloh Mr. Hustler 22M**  
**22**      **SCCA 22M**      2359270      January 12 2024

RED BECKTON HUSTLER T615 C2  
**Sire: RED ML HUSTLER 272Z**  
 RED ML KARUBA 814U

RED BECKTON HUSTLER C2 L079  
 RED BECKTON ROSE H074 EP  
 RED CROWFOOT 6253S  
 RED BAR-X KARUBA 101J

RED DKF RACER 8E  
**Dam: RED SHILOH HIGHLIFE 135H**  
 RED SHILOH ELEGANT LADY 107E

RED DKF RAZOR 55C  
 RED DKFE MISS ACE 84C  
 RED ML HUSTLER 272Z  
 RED SHILOH YUKON TOUR 4Y

Canadian Angus Association EPDs									
Act. BW	Adj. WW	BW	WW	YW	Milk	CE	MCE	CE Score	
84	686	2.4	53	90	23	4	8	★★★	

# SHILOH CATTLE COMPANY



A sound made, strong topped bull with great rib shape. His young Dam has performed impressively, with all 3 of her offspring making the sale pens. Hustler continues to impress us with calves like the ones in this sire group.

**Lot 23** *Red Shiloh Mr. Hustler 23M*  
 SCCA 23M 2359271 January 12 2024

Act. BW	Adj. WW	BW	Canadian WW	Angus YW	Association Milk	EPDs CE	MCE	CE Score
85	710	3.3	54	90	24	0	6	★★

Sire: RED BECKTON HUSTLER T615 C2  
 RED ML HUSTLER 272Z  
 RED ML KARUBA 814U

RED BECKTON HUSTLER C2 L079  
 RED BECKTON ROSE H074 EP  
 RED CROWFOOT 6253S  
 RED BAR-X KARUBA 101J

Dam: RED DKF RACER 8E  
 RED SHILOH HEART OF ARDATH 47H  
 RED LAURON ARDATH 185A

RED DKF RAZOR 55C  
 RED DKFE MISS ACE 84C  
 RED TER-RON WALLACE 142W  
 RED LAURON ARDATH 1P



Sound and solid like his sire. Lot 24's Grand Dam is a herd favourite. We have retained all of her female offspring.

**Lot 24** *Red Shiloh Mr. Hustler 24M*  
 SCCA 24M 2359272 January 12 2024

Act. BW	Adj. WW	BW	Canadian WW	Angus YW	Association Milk	EPDs CE	MCE	CE Score
84	661	1.9	48	79	21	3	6	★★★

Sire: RED BECKTON HUSTLER T615 C2  
 RED ML HUSTLER 272Z  
 RED ML KARUBA 814U

RED BECKTON HUSTLER C2 L079  
 RED BECKTON ROSE H074 EP  
 RED CROWFOOT 6253S  
 RED BAR-X KARUBA 101J

Dam: RED DKF RACER 8E  
 RED SHILOH HOTLINE 24H  
 RED SHILOH EVERLASTING 6E

RED DKF RAZOR 55C  
 RED DKFE MISS ACE 84C  
 RED SHILOH ACTIVELY LOADED 81A  
 RED SHILOH A HOT PURSUIT 8A

**Lot 25** *Red Shiloh Mr. Hustler 27M*  
 SCCA 27M 2359276 January 13 2024

**Sire:** RED BECKTON HUSTLER T615 C2  
 RED BECKTON ROSE H074 EP  
 RED CROWFOOT 6253S  
 RED BAR-X KARUBA 101J

**Dam:** RED REDRICH BUMPER CROP 336B  
 RED REDRICH SIZZLER 609Z  
 RED REDRICH FIRST LADY 336W  
 RED SCCA U.N. MAJOR 35U  
 RED SHILOH TOPAZ 15T

Act. BW	Adj. WW	BW	Canadian WW	Angus YW	Association Milk	CE	MCE	EPDs	CE Score
80	630	0.5	41	68	24	6	6		★★★

A Hustler son with a comfortable degree of calving ease. Solid, balanced udder structure and positive maternal traits are reflected in this bulls cow family.



**Lot 26** *Red Shiloh Mr. Hustler 35M*  
 SCCA 35M 2359284 January 15 2024

**Sire:** RED BECKTON HUSTLER T615 C2  
 RED BECKTON ROSE H074 EP  
 RED CROWFOOT 6253S  
 RED BAR-X KARUBA 101J

**Dam:** RED REDRICH BUMPER CROP 336B  
 RED REDRICH SIZZLER 609Z  
 RED REDRICH FIRST LADY 336W  
 RED SCCA XCITEABULL SAKIC 5X  
 RED SHILOH ZESTY 35Z

Act. BW	Adj. WW	BW	Canadian WW	Angus YW	Association Milk	CE	MCE	EPDs	CE Score
95	729	2	51	89	27	3	5		★

A masculine, wide topped cow bull that's sure to add some performance to your calf crop. This bull's maternal Grand Sire was utilized to produce solid females with extremely well balanced udders.



**Lot 27** *Red Shiloh Mr. Hustler 37M*  
 SCCA 37M 2359286 January 15 2024

**Sire:** RED BECKTON HUSTLER T615 C2  
 RED BECKTON ROSE H074 EP  
 RED CROWFOOT 6253S  
 RED BAR-X KARUBA 101J

**Dam:** RED SCCA XCITEABULL SAKIC 5X  
 RED SIX MILE SAKIC 832S  
 RED TOMAHAWK ROSETTE 36S  
 RED SCCA U.N. MAJOR 35U  
 RED SHILOH UNA 4U

Act. BW	Adj. WW	BW	Canadian WW	Angus YW	Association Milk	CE	MCE	EPDs	CE Score
98	644	2.9	46	73	22	0	4		★

Consider this Hustler son for your cow pen this summer. A solid made bull that's sure to get results when weaning next fall.



# SHILOH CATTLE COMPANY



Justin is a herd sire that excels in calving ease, performance and milk, making him a true dual purpose herd sire. He consistently passes on qualities like impressive depth of rib, hip shape and a dark red hair coat to his easy fleshing offspring.

*Sire* **Red Lauron Justin Time 113J**  
 RLH 113J      2216111      February 19, 2021

RED 5L TRADIN RIGHT 9010-45A  
**Sire: RED JEWEL TRADIN RIGHT 108D**  
 RED JEWEL CHEROKEE 23B

RED BUF CRK THE RIGHT KINDU199  
 RED 5L SKIJA 2375-9010  
 RED GEIS MISSION 221'11  
 RED JEWEL MISS CHEROKEE8Z

RED LAURON BLOCK BUSTER 78B  
**Dam: RED LAURON MOROJITTI 7D**  
 RED LAURON MOROJITTI 128B

RED BIEBER ROLLIN DEEP Y118  
 RED LAURON GENIE 138U  
 RED MAC PACKER 136Z  
 RED LAURON MOROJITTI 158W

Canadian Angus Association EPDs									
Act. BW	Adj. WW	Adj. YW	BW	WW	YW	Milk	CE	MCE	
90	785	1385	0	47	80	27	6	5	



43M is an athletic, calving ease Justin son with a little extra frame, bringing the confidence that he will get the job done in both the heifer and cow pen.

*Lot* **Red Shiloh Mr. Justin 43M**  
**28**      SCCA 43M      2359296      January 17 2024

RED JEWEL TRADIN RIGHT 108D  
**Sire: RED LAURON JUSTIN TIME 113J**  
 RED LAURON MOROJITTI 7D

RED 5L TRADIN RIGHT 9010-45A  
 RED JEWEL CHEROKEE 23B  
 RED LAURON BLOCK BUSTER 78B  
 RED LAURON MOROJITTI 128B

RED ALLISON RED BONE 69E  
**Dam: RED SHILOH HEARTBREAKER 130H**  
 RED SHILOH ENTOURAGE 33E

RED WPRA RIGHT TURN C521  
 RED BAR-E-L BESS 214C  
 RED ML HUSTLER 272Z  
 RED SHILOH AFTERGLOW 19A

Canadian Angus Association EPDs									CE Score
Act. BW	Adj. WW	BW	WW	YW	Milk	CE	MCE		★★★★★
78	649	0.6	42	73	28	6	7		

59M is a dark coated, deep sided, well balanced bull with a solid +26 milk EPD. These bulls from the Justin sire group are always some of the most impressive made in the sale pen.



*Lot*  
**29** *Red Shiloh Mr. Justin 59M*  
SCCA 59M 2359619 January 21 2024

Act. BW	Adj. WW	BW	Canadian WW	Angus YW	Association Milk	EPDs CE	MCE	CE Score
79	644	-0.5	37	65	26	6	7	★★★★

Sire: RED JEWEL TRADIN RIGHT 108D  
RED LAURON JUSTIN TIME 113J  
RED LAURON MOROJITTI 7D

RED 5L TRADIN RIGHT 9010-45A  
RED JEWEL CHEROKEE 23B  
RED LAURON BLOCK BUSTER 78B

Dam: RED MAR MAC DEBUT 70D  
RED SHILOH FRANCHISE 28F  
RED TNF KASSIE 27A

RED LAURON MOROJITTI 128B  
RED WINDY HILL ZEPPELIN 1240Z  
RED MCRAE'S RUBY 10T  
RED FINE LINE MULBERRY 26P  
RED BAR-E-L KASSIE 3P

A performance driven bull to consider for use in your cow pen this breeding season. He's sure to add some extra pounds to your calves next fall.



*Lot*  
**30** *Red Shiloh Mr. Justin 78M*  
SCCA 78M 2359638 January 27 2024

Act. BW	Adj. WW	BW	Canadian WW	Angus YW	Association Milk	EPDs CE	MCE	CE Score
94	719	2.5	52	91	21	-2	2	★

Sire: RED JEWEL TRADIN RIGHT 108D  
RED LAURON JUSTIN TIME 113J  
RED LAURON MOROJITTI 7D

RED 5L TRADIN RIGHT 9010-45A  
RED JEWEL CHEROKEE 23B  
RED LAURON BLOCK BUSTER 78B  
RED LAURON MOROJITTI 128B

Dam: RED LAZY MC HONKY TONK 11X  
RED SHILOH BORN 2 HONKY TONK 5B  
RED SHILOH WATLING 88W

RED LAZY MC COWBOY CUT 26U  
RED YY PATTY 701T  
RED ROD ELIXIR 39T  
RED SHILOH TERRA 20T

# SHILOH CATTLE COMPANY



Don't overlook this outstanding Justin son. He is impressively deep ribbed and strong topped.

*Lot*  
**31** *Red Shiloh Mr. Justin 104M*  
SCCA 104M      2359827      February 07 2024

RED JEWEL TRADIN RIGHT 108D  
**Sire: RED LAURON JUSTIN TIME 113J**  
RED LAURON MOROJITTI 7D

RED 5L TRADIN RIGHT 9010-45A  
RED JEWEL CHEROKEE 23B  
RED LAURON BLOCK BUSTER 78B  
RED LAURON MOROJITTI 128B

RED MAR MAC DEBUT 70D  
**Dam: RED SHILOH HIGHLIFE 34H**  
RED SHILOH ANNIE 30A

RED WINDY HILL ZEPPELIN 1240Z  
RED MCRAE'S RUBY 10T  
RED SCCA UNSUNG MARIAS 86U  
RED SHILOH XTOCICITY 44X

Act. BW		Adj. WW		Canadian Angus Association EPDs		MCE		CE Score
BW	WW	BW	WW	YW	Milk	CE	MCE	★ ★ ★
85	674	0.8	45	76	25	2	2	



Calving ease with performance, as well as a strong milk EPD makes this guy worth a good look. His Dam is a well built and balanced female with a beautiful udder.

*Lot*  
**32** *Red Shiloh Mr. Justin 113M*  
SCCA 113M      2359834      February 14 2024

RED JEWEL TRADIN RIGHT 108D  
**Sire: RED LAURON JUSTIN TIME 113J**  
RED LAURON MOROJITTI 7D

RED 5L TRADIN RIGHT 9010-45A  
RED JEWEL CHEROKEE 23B  
RED LAURON BLOCK BUSTER 78B  
RED LAURON MOROJITTI 128B

RED ALLISON RED BONE 69E  
**Dam: RED SHILOH HARMONY 10H**  
RED WOOD COULEE RAMBO 721E

RED WPRA RIGHT TURN C521  
RED BAR-E-L BESS 214C  
RED WOOD COULEE CREDIT 159B  
RED RC MISS RAMBO 49S

Act. BW		Adj. WW		Canadian Angus Association EPDs		MCE		CE Score
BW	WW	BW	WW	YW	Milk	CE	MCE	★ ★ ★ ★
75	772	1.0	52	86	27	3	6	





2025 Bull Clipping Crew



Champion Purebred Pen of Heifers

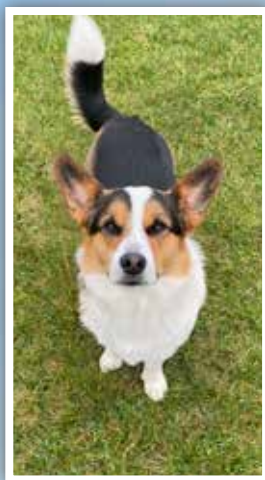

The Ranch Foreman



Our Future Local Cattlemen & Women



We Still Believe in a Handshake



Agribition 2024



2024 Angus Field Day and AGM



# SHILOH CATTLE COMPANY



Franchise is a breed leader with proven CE and maternal excellence. A favored female maker, many of his daughters are leading donors in Red Angus programs across North America. His phenotype is impressive and offers extra muscle shape and dimension to his offspring.

*Sire* **Red 9 Mile Franchise 6305**  
 IMP 6305D      2017139      March 02 2016

SPUR FRANCHISE 7070  
**Sire: SPUR FRANCHISE OF GARTON**  
 H&H IRENE LASS 0135

RED TR COLT 45 UT806  
**Dam: RED C-BAR ABIGRACE Y11**  
 RED C-BAR & BROWN ABIGRACET714

BASIN FRANCHISE P142  
 H&H L&C LADY BEHAVE 5040  
 SYDGEN C C & 7  
 H&H IRENE LASS 7116

RED BECKTON CODY V E023  
 RED BECKTON COCA L388 CK  
 RED LJC MISSION STATEMENT P27  
 RED BROWN MS ABIGRACE L7730

Act. BW	Adj. WW	Adj. YW	Canadian Angus Association EPDs				CE	MCE
n/a	n/a	n/a	BW	WW	YW	Milk	CE	MCE
			-2.3	42	86	39	10	4



One of the most attractive bulls in this year's sale pen. An extremely long sided bull with a nice skull set. He is sure to provide you with attractive replacement heifers. We are very impressed with our Franchise females.

*Lot* **Red Shiloh Mr. Franchise 13M**  
**33**      SCCA 13M      2359246      January 09 2024

SPUR FRANCHISE OF GARTON  
**Sire: RED 9 MILE FRANCHISE 6305**  
 RED C-BAR ABIGRACE Y11

RED WILDMAN CHUCK NORRIS 012X  
**Dam: RED SHILOH CUPID 52C**  
 RED TOMAHAWK LADY 54P

SPUR FRANCHISE 7070  
 H&H IRENE LASS 0135  
 RED TR COLT 45 UT806  
 RED C-BAR & BROWN ABIGRACET714

RED WILDMAN RIO GRANDE 520R  
 RED DWAJO PRALEE 78M  
 RED FCF MR. BJR 105 1092M  
 RED TOMAHAWK LADY 52M

Act. BW	Adj. WW	Adj. BW	Canadian Angus Association EPDs				CE	MCE	CE Score
			BW	WW	YW	Milk	CE	MCE	★ ★ ★
85	683	1.5	42	80	29	2	3		

Another solid Franchise son with a high degree of calving ease and an outstanding +30 milk EPD. We think this bull will make an impressive impact.



Lot **34** *Red Shiloh Mr. Franchise 25M*  
 SCCA 25M 2359273 January 12 2024

Act. BW	Adj. WW	BW	Canadian WW	Angus YW	Association Milk	EPDs CE	MCE	CE Score
75	588	-0.6	32	61	30	6	7	★★★★

SPUR FRANCHISE OF GARTON  
 Sire: **RED 9 MILE FRANCHISE 6305**  
 RED C-BAR ABIGRACE Y11

RED COCKBURN ASSASSIN 624D  
 Dam: **RED SHILOH GRACE 5G**  
 RED SHILOH ZUMBA 66Z

SPUR FRANCHISE 7070  
 H&H IRENE LASS 0135  
 RED TR COLT 45 UT806  
 RED C-BAR & BROWN ABIGRACET714  
 RED PIE SPECIALIST 430  
 RED COCKBURN CORA 254Z  
 RED SCCA U.N. MAJOR 35U  
 RED SHILOH TRYSTA 8T

*Country Junction Feeds is proud to sponsor Shiloh Cattle Company's 11th Annual Bull Sale. Please join us for the Wine & Cheese and Beer & Sausage Social after the sale.*



**Proudly providing nutrition solutions to Alberta beef producers for the last 6 decades**

*Premium nutrition to complement premium genetics*

**Country Junction Feeds maintains a complete line of cattle feed trusted at top Ranches across Alberta**



**(780) 352-9155**  
**www.countryjunctionfeeds.com**

# SHILOH CATTLE COMPANY



In 2018 and 2019 Racer made his mark in the cattle industry as the most decorated Red Angus bull in Canada, as well as the North American Silver (2018) and Bronze Medalist (2019) in the Angus breed. His offspring are well balanced and stride out with the power and correctness of their sire, and have outstanding leg and foot structure.

*Sire* **Red DKF Racer 8E**  
DKFE 8E      1974618      January 18, 2017

DKF ELIMINATOR 15A  
**Sire: RED DKF RAZOR 55C**  
DKF MISS NET WORTH 21A

S A V ELIMINATOR 9105  
RED DKF MISS POWER 17P  
S A V NET WORTH 4200

RED SOO LINE POWER EYE 161X  
**Dam: RED DKFE MISS ACE 84C**  
RED BLU DAWN MISS ILLICIT 359Z

DKF MISS POWER UP 95X  
RED COCKBURN RIBEYE 308U  
RED TR LYNN 301R  
RED U-2 ILLICIT 423P  
RED BLU DAWN MISS ROBBIE 395T

Act. BW	Adj. WW	Adj. YW	Canadian Angus Association EPDs					
BW	WW	YW	BW	WW	YW	Milk	CE	MCE
78	764	n/a	-0.2	36	68	13	10.0	13.0



A smooth shouldered, calving ease option. Racer calves always come easy for that extra degree of comfort in your heifer pen next spring.

*Lot* **Red Shiloh Mr. Racer 29M**  
**35**      SCCA 29M      2359279      January 14 2024

RED DKF RAZOR 55C  
**Sire: RED DKF RAZOR 8E**  
RED DKFE MISS ACE 84C

DKF ELIMINATOR 15A  
DKF MISS NET WORTH 21A  
RED SOO LINE POWER EYE 161X  
RED BLU DAWN MISS ILLICIT 359Z

RED SHILOH DOMAIN 92D  
**Dam: RED SHILOH GIFT 112G**  
RED SHILOH DREAM CATCHER 18D

RED ML HUSTLER 272Z  
RED SHILOH ZIN ZIN 57Z  
RED SHILOH ACTIVELY LOADED 81A  
RED SHILOH ZODIAC 44Z

Act. BW	Adj. WW	BW	Canadian Angus Association EPDs					CE Score
BW	WW	YW	BW	WW	YW	Milk	CE	MCE
87	678	1.6	43	75	20	4	9	★★★



Lot **36** *Red Shiloh Duchess 21M*  
 SCCA 21M 2359269 January 11 2024

Act. BW	Adj. WW	BW	Canadian WW	Angus YW	Association Milk	EPDs CE	MCE
61	563	-2.8	37	59	23	11	9

Sire: RED JEWEL TRADIN RIGHT 108D  
 RED LAURON JUSTIN TIME 113J  
 RED LAURON MOROJITTI 7D

RED 5L TRADIN RIGHT 9010-45A  
 RED JEWEL CHEROKEE 23B  
 RED LAURON BLOCK BUSTER 78B  
 RED LAURON MOROJITTI 128B

Dam: RED MAR MAC DEBUT 70D  
 RED SHILOH HEARTLAND 4H  
 RED SHILOH CHARRO 65C

RED WINDY HILL ZEPPELIN 1240Z  
 RED MCRAE'S RUBY 10T  
 RED SCCA XCITEABULL SAKIC 5X  
 RED SHILOH ZIPPY PURSUIT 1Z



Lot **37** *Red Shiloh Lady 38M*  
 SCCA 38M 2359288 January 15 2024

Act. BW	Adj. WW	BW	Canadian WW	Angus YW	Association Milk	EPDs CE	MCE
77	586	2.7	43	75	22	2	7

Sire: RED SIX MILE JOHN WICK 882E  
 RED SIX MILE MR WICK 169H  
 RED SIX MILE RUBY 233E

RED U-2 RECKONING 149A  
 RED SIX MILE & CO GLORIA 29A  
 RED HALL'S BARRY 040C  
 RED SVR RUBY 16P

Dam: RED DKF RACER 8E  
 RED SHILOH GENUINELY COOL 59G  
 012X RED SHILOH ELUSIVE 32E

RED DKF RAZOR 55C  
 RED DKFE MISS ACE 84C  
 RED WILDMAN CHUCK NORRIS  
 RED SHILOH WILLIEMINA 3W

# SHILOH CATTLE COMPANY



Lot **38** *Red Shiloh Madcaps 41M*  
 SCCA 41M 2359293 January 16 2024

Sire: **RED DKF RAZOR 55C**  
**RED DKF RACER 8E**  
 RED DKFE MISS ACE 84C

DKF ELIMINATOR 15A  
 DKF MISS NET WORTH 21A  
 RED SOO LINE POWER EYE 161X  
 RED BLU DAWN MISS ILLICIT 359Z

Dam: **RED ALLISON RED BONE 69E**  
**RED SHILOH HAZEL 50H**  
 RED SHILOH CHARMAINE 81C

RED WPRA RIGHT TURN C521  
 RED BAR-E-L BESS 214C  
 RED SCCA XCITEABULL SAKIC 5X  
 RED SHILOH ZENOBIA 38Z

Act. BW	Adj. WW	BW	Canadian Angus Association EPDs				
			WW	YW	Milk	CE	MCE
75	598	1.4	36	69	19	5	9



Lot **39** *Red Shiloh Rosette 86M*  
 SCCA 86M 2359645 January 31 2024

Sire: **RED DKF RAZOR 8E**  
**RED SHILOH HOLLYWOOD 129H**  
 RED LAURON MOROJITTI 127A

RED DKF RAZOR 55C  
 RED DKFE MISS ACE 84C  
 RED GLACIER LOGAN  
 RED LAURON MOROJITTI 82R

Dam: **RED DKF RAZOR 8E**  
**RED SHILOH ROSETTE 7J**  
 RED SHILOH CANADIAN GAL 32C

RED DKF RAZOR 55C  
 RED DKFE MISS ACE 84C  
 RED WILDMAN CHUCK NORRIS 012X  
 RED SHILOH YOU MISS MOOSE 93Y

Act. BW	Adj. WW	BW	Canadian Angus Association EPDs				
			WW	YW	Milk	CE	MCE
74	603	2.4	33	61	23	2	9

*We would like to recognize and extend a special thanks to the following buyers for purchasing the high selling lots in our 2024 sale.*



2024 High Selling Red Angus Bull

Red Shiloh Let's Rumble 54L

Purchased by: Purchased by: CD Land & Cattle



2024 High Selling Angus Bull

Shiloh Liberation 40L

Purchased by: Neu Muehl Colony



2024 High Selling Red Angus Heifer

Red Shiloh Lady 47L

Purchased by: KBH Farms



2024 High Selling Angus Heifer

Shiloh Edge Pride 46L

Purchased by: Schilling Farms

# SHILOH CATTLE COMPANY

## *Trendsetter Sale Replacement Heifers*

Approximately 50 Open Replacement Heifers from the following consigners. All heifers will be palpated and Vet checked. HEIFER PACKAGES are to be picked up sale day unless other arrangements are made. Please contact Darcy or Blake to discuss options.

### *Misty Ridge Ranch Ltd.*

Kelby Stevens 403-820-5518

Tenille Stevens 403-664-5184

The Stevens farm is located in the Hand Hills and they produce quality Red Angus cattle focusing on easy keeping, docile, high yielding females. Generations of genetics have been developed to ensure replacement heifers will add performance to any herd. Their Red Angus heifers are one iron. Their herd health has been Bovishield One Shot, Meloxi-cam and Ultrabac7/som at branding. Bovishield Gold FPS in February.

### *Neu Muehl Colony*

Ted Wipf 403-821-1509

Neu Muehl Colony is in the Hand Hills near Drumheller. The Colony was founded in 2000 and has been raising quality Angus and Angus Simmental cattle ever since. This group of heifers was selected from a group of 300 heifers. Ted let Shiloh Cattle Company have first pick before selecting heifers for them selves. There will be packages of Reds and Blacks. These are all one iron heifers that have been under the Merck Animal Health program.

### *Shiloh Cattle Company*

Blake Morton 403-820-4162

Darcy Olesky 403-820-1830

Shiloh is once again offering a top cut of Red Angus Heifers. These heifers are out of proven genetics that have sisters and dams working in the Shiloh herd. These heifers have been managed under a Bovisheild Gold program. There are no brands on these quiet pail fed heifers.





## *Terms & Conditions*

1. **TERMS:** The terms of the sale are cash or cheque payable in Canadian funds unless previous arrangements have been with individual consigners. Settlement prior to any cattle released. As soon as an animal is sold, it becomes the responsibility of the purchaser. Any animal remaining at Shiloh Cattle Company must be Insured. Livestock coverage will be available from the clerk's desk on sale day.
2. **CERTIFICATE AND REGISTRY:** Certificate of registry dually transferred will be furnished to the buyer for each registered animal after complete and full payment has been made.
3. **IDENTIFICATION:** Each animal will carry a CCIA digital frequency tag as well as a ear tag.
4. **BREEDERS GUARANTEE:** All cattle are sound and right to sell with a responsible breeder guarantee of satisfaction. In the event of an unlikely dispute, the regular terms and conditions standard with the Canadian Aberdeen Angus Association shall apply. Any complaints regarding fertility of any animal in the sale shall be directed to the breeder. No incidental expense such as feed, veterinarian charges, interest, etc., will be charged by either party. Under no circumstances shall the seller be responsible for more than the purchase price paid for the bull.
5. **ACCIDENTS:** Although every precaution will be taken to protect the safety and comfort of any who attend the sale, neither the sales management, the sponsoring association nor any owner assumes responsibility in this matter and disclaims any liability legal or otherwise, in the event of accident or loss of property.
6. **LIABILITY:** Purchasers must look to the seller for fulfillment of all guarantees and representation made hereafter.
7. **DISPUTES:** In the case of disputes, bidding will be reopened between the parties involved. If no further bid is made, the buyer will be the person from which the auctioneer accepted the last bid.
8. Shiloh Cattle Company retains the right to draw owners use semen on all bulls offered in the sale. This will be done before the sale, or at the new owners convenience and at our own cost.
9. **ANNOUNCEMENTS:** Errors or omissions discovered in the catalogue will be corrected by announcement from the auction stand at sale time and such corrections will take precedents over the printed manner in this catalogue.



# SHILOH CATTLE COMPANY

*We would like to thank the following buyers for making our 2024 Bull and Replacement Heifer Sale so successful.*

CD Land & Cattle \*  
 Mike Gross & Family  
 Dzurko Ranch \*  
 Cottonwood Livestock \*  
 Neu Muehl Colony \*  
 Misty Ridge Ranch \*  
 Neilson Land & Cattle  
 Cale Downey \*  
 CJS Farms  
 Wyatt Grauman \*  
 Mashon Ranches \*  
 Hecker Farms Ltd. \*  
 Steven & Shannon Verga \*  
 Brooke Family Farm \*  
 RV White Ranches Ltd. \*  
 Keven & Norma Jean Minchau \*  
 Mike & Jodie Gordon \*  
 Ron Guenther

Geoff Hunt  
 James Sorensen  
 K-6 Farms / Earl Kehler  
 Clay Willams  
 Nelson Ag \*  
 KBH Farms \*  
 Terry & Carol Beck \*  
 Patchell Livestock \*  
 Brian & Addison Newman  
 Schilling Farms  
 Ryan McLaughlin \*  
 Alisha Minchau \*  
 Circle Seven Ranch \*  
 Rob Scheler \*  
 Lochart Ranches \*  
 Dave Shand \*

\* Indicates Repeat Customer.

*We have enjoyed meeting all of our new buyers and would like to extend a special thank you to our repeat customers. Over the years, we have acquired a deep sense of pride and accomplishment in our cattle herd and breeding stock. Thank you to each and every one of you that have expressed your continued confidence in our bull and replacement heifer programs. We wish you all continued success and look forward to meeting again in 2026.*

*We will also be hosting a Tailgate Party on Sunday, March 16th down at the sale pens one week prior to this year's Sale.*

*Join us for a Bon Fire & view the sale animals on offer. Hotdogs and refreshments will be on hand.*

*Everyone viewing the Sale Pens on the 16th will be entered to win one of two \$500 credit vouchers towards this year's Trendsetter Bull Sale.*



*Thank you for attending our  
11th annual "Trendsetter" Bull Sale.  
We look forward to seeing you again in 2026.*

*Darcy & Blake.*



SHILOH CATTLE COMPANY  
R.R. 3  
Craigmyle, AB  
T0J 0T0



RETURN POSTAGE GUARANTEED  
PORT DE RETOUR GARANTI



# TRENDSETTER BULL & SELECT REPLACEMENT HEIFER SALE

At The Ranch  
Hand Hills Lake, Alberta

Saturday, March 22, 2025